

Incremental Rotary Encoder 60 mm dia.

# E6F-C

## The Strongest Shaft for Tough Jobs

- The strongest shaft of any OMRON Incremental Encoder (120 N in radial direction and 50 N in thrust direction).
- Water- and oil-proof structure (IP65f)
- Output short-circuit protection circuit to reduce risks from incorrect wiring.
- Complementary output model can be used with extension cable
- Shock resistance strengthened by metal disk. (600 P/R max.) (Patent)



## Ordering Information

### Sensors

Supply voltage	Output form	Resolution (pulse/rotation)	Model
12 to 24VDC	Complimentary output	100, 200, 360, 500, 600 1000	<b>E6F-CWZ5G</b>

### Accessories (Order Separately)

Item	Model	Remarks
Coupling	<b>E69-C10B</b>	---
	<b>E69-C610B</b>	Different end diameter
	<b>E69-C10M</b>	Metal construction
Mounting Bracket	<b>E69-2</b>	Three brackets in a set; included with the Encoder.

## Dimensions (Unit: mm)

### Sensors

#### E6F-CWZ5G

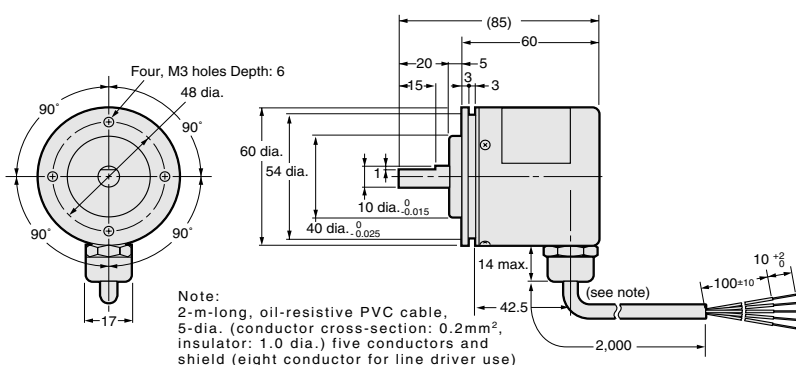

### Accessories (Order Separately)

#### Servo Mounting Bracket

#### E69-2

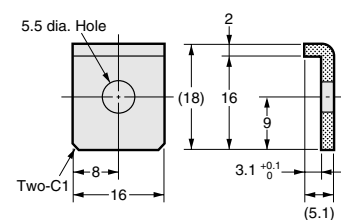

ALL DIMENSIONS SHOWN ARE IN MILLIMETERS.

To convert millimeters into inches, multiply by 0.03937. To convert grams into ounces, multiply by 0.03527.